

## SYSTEM DESCRIPTION

CastorCrete CM is a heavy duty mortar that is designed for troweling cove, to be installed 1/8 to 1/4 inch thick.

CastorCrete CM has a coefficient of thermal expansion similar to concrete which allows it to maintain adhesion when subjected to the thermal shock of hot water or steam cleaning. It can be used at constant service temperatures up to 212°F (100°C).

## USES

- Areas exposed to strong acids, alkali, hot oils, animal fats and most solvents

## ADVANTAGES

- Low Order During Placement and Cure
- Fast Installation
- Moisture Tolerant
- Thermal Shock Resistant
- Impact and Abrasion Resistant
- Chemical Resistant to Organic and Inorganic Acids, Salts, Alkalies and Amines
- Superior Life Cycle Advantages

## COLORS

5 standard colors and natural.

## TECHNICAL DATA

Tensile Strength (ASTM C-307)	1,400 psi
Flexural Strength (ASTM C-580)	3,321 psi
Hardness, Shore D (ASTM D-2240)	85
Impact Resistance (ASTM D-2794)	160 in-lb
Bond Strength (ASTM D-7234)	Concrete Failure

Refer to product data sheet of individual system component for more information.

## TYPICAL SYSTEM BUILD

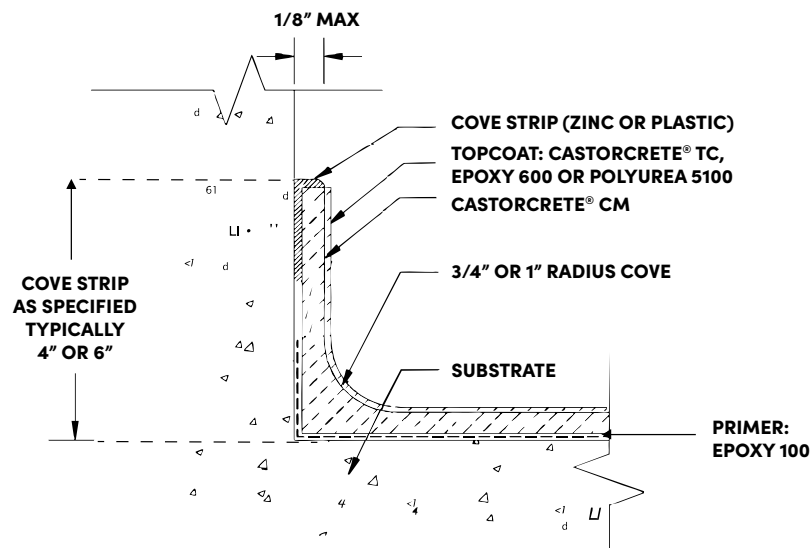

DIAGRAM NOT TO SCALE

## TYPICAL SYSTEM BUILD

COAT	PRODUCT	THICKNESS/COVERAGE
Primer	APF Epoxy 100	200 sq. ft./gallon (8 mils WFT)
Mortar Coat	APF CastorCrete CM	1/8"-1/4" (15-30 linear ft/32 lb kit)
Topcoat Option 1	APF CastorCrete TC	140-280 sq. ft./gallon (10-20 mils)*
Topcoat Option 2	APF Epoxy 600	100 sq. ft./gallon (16 mils)*
Topcoat Option 3	APF Polyurea 5100	200 sq. ft./gallon (8 mils)*

\*Topcoat coverage determines final texture.

## APPLICATION INSTRUCTIONS

### 1.0 Concrete Moisture

It is the applicator's responsibility to test and record concrete moisture levels according to ASTM F2170-19. Contact APF Technical Service if the relative humidity exceeds 99%.

### 2.0 Surface Preparation

Concrete must be cured for at least 7-10 days be clean, structurally sound, and free of wax, loose coatings or curing compounds. Concrete should be properly prepared to achieve a surface Minimum Texture of ICRI/CSP 3. Refer to ICRI technical guidelines 310-330 Selecting and specifying concrete surface preparation for sealer, coatings, polymer overlays, and concrete repair. Vacuum the prepared concrete surface to remove all dust. Acid etching is not recommended and will void manufacturers' warranty.

### 3.0 Application of Primer Coat

Apply Epoxy 100 onto the surface immediately after mixing with a brush or mini roller (solvent-resistant 3/8-inch nap roller cover). Apply at a rate of 200 sqft/gallon at 8 mils WFT. A "wet edge" is recommended when applying the product; do not attempt to roll over material that has started to set. CastorCrete CM must be applied while the primer is still tacky. If the primer dries before the mortar is used, it must be reapplied.

### 4.0 Application of CastorCrete CM

Do not apply to previously coated surfaces; apply directly to concrete except for when priming is necessary. After thoroughly mixing CastorCrete CM in accordance with the product data sheet, trowel in place using a steel concrete trowel. If a radius is desired, a 3/4-inch radius coving trowel can be used to finish the mortar. As soon as the troweling is complete, lightly brush or roll the CastorCrete CM to bring the resin to the top removing any minor imperfections.

### 5.0 TopCoat Application Options (Apply one of the following)

After mixing the CastorCrete TC according to the product data sheet, apply CastorCrete TC onto the surface immediately after mixing with a squeegee, then back roll using a quality solvent-resistant 3/8-inch nap roller at a rate of 140-280 sq ft per gallon (10-20 mils). When applying the cementitious polyurethane topcoat, maintain a "wet edge" between mixes. Place each batch within the working time of the previous batch. Failing to do this could result in a visible tie-in line.

Epoxy 600: As soon as the mortar can be walked on, apply Epoxy 600 clear after mixing per the product data sheet at a rate of 100 sqft/gallon (16 mils WFT).

Polyurea 5100: As soon as the mortar can be walked on, apply Polyurea 5100 clear after mixing per the product data sheet at a rate of 200 sqft/gallon (8 mils WFT).

## LIMITATIONS

- Prior to application, measure and confirm that ambient temperature and substrate temperature are at least 5°F over dew point.
- High humidity/low temperature will prolong cure time.
- Use of kerosene or propane forced air heating equipment during application may cause discoloration and finish defects.

## HANDLING & SAFETY

Use only with adequate ventilation. Appropriate cartridge-type respirator must be used during application in confined areas. Avoid contact with skin; wear protective gloves. User must read and understand Safety Data Sheet before using. APF Safety Data Sheets are available at [www.apfepoxy.com](http://www.apfepoxy.com).

APF\_CastorCrete\_CM\_System\_Data\_01.05.26

#### STANDARD WARRANTY STATEMENT

ICP Construction, Inc. ("we" "us" or "our"), manufacturer of Arizona Polymer Flooring, warrants that the product is produced within specifications and is free from defects in material only. No warranty shall be in effect until our Terms and Conditions of Sales (<https://www.icpgroup.com/wp-content/uploads/ICP-Group-Terms-and-Conditions-of-Sale.pdf>) are met, including payment and cooperative promotional considerations. We warrant that the covered product is free of defects in material only and suitable for the specified purpose for a period of one (1) year from the date of shipment, provided the product is (a) installed within its published shelf life, in strict conformance with specifications, and (b) handled, stored, mixed, and applied in accordance with our written instructions. It is your responsibility to initiate any claim against this warranty within the time frame specified below. If we determine that the product meets the requirements of this warranty, then we will, at our sole discretion, either refund the purchase price of the product or provide replacement product, in each case not to exceed the affected area as determined by our authorized technical representative. To obtain replacement or refund you must (a) provide timely written notice to us specifying in detail the non-conformity suspected (no later than five (5) working days after discovery), and (b) provide proof of purchase. We reserve the right to inspect the product prior to replacement. EXCEPT FOR THE EXPRESS WARRANTY ABOVE, THERE ARE NO OTHER WARRANTIES, EXPRESS OR IMPLIED, INCLUDING WITHOUT LIMITATION ANY IMPLIED WARRANTY OF MERCHANTABILITY OR FITNESS FOR PURPOSE. IN NO EVENT SHALL WE OR OUR AFFILIATES BE LIABLE FOR ANY INDIRECT, SPECIAL, INCIDENTAL, PUNITIVE, OR CONSEQUENTIAL DAMAGES OF ANY NATURE, REGARDLESS OF THE FORM OF ACTION OR THEORY OF LAW, INCLUDING, WITHOUT LIMITATION, BREACH OF ANY OBLIGATION OR WARRANTY IMPOSED ON US HEREUNDER OR IN CONNECTION HERewith, EVEN IF WE HAVE BEEN ADVISED OF THE POSSIBILITY OF SUCH DAMAGES IN ADVANCE AND EVEN IF A REMEDY SET FORTH HEREIN IS FOUND TO HAVE FAILED OF ITS ESSENTIAL PURPOSE. "CONSEQUENTIAL DAMAGES" SHALL INCLUDE, WITHOUT LIMITATION, LOSS OF USE, INCOME, OR PROFIT, OR LOSSES SUSTAINED AS THE RESULT OF INJURY TO ANY PERSON, OR LOSS OF OR DAMAGE TO ANY PROPERTY (INCLUDING, WITHOUT LIMITATION, PROPERTY HANDLED OR PROCESSED THROUGH THE USE OF THE PRODUCTS), DAMAGES OR LOSSES RESULTING FROM CLAIMS OF OTHER PERSONS AGAINST YOU, OR DAMAGES OR LOSSES SUSTAINED AS THE RESULT OF WORK STOPPAGE, OR REMOVAL AND REPLACEMENT COSTS AND COSTS OF LABOR. IN NO EVENT SHALL OUR LIABILITY ARISING IN CONNECTION WITH OR UNDER THIS WARRANTY (REGARDLESS OF THE FORM OF ACTION OR THEORY OF LAW) EXCEED THE AMOUNT PAID BY YOU FOR THE DEFECTIVE PRODUCT ONLY. THIS LIMITED WARRANTY PROVIDES YOUR EXCLUSIVE REMEDY FOR ANY DEFECT IN THE PRODUCT. If you do not agree with these terms, you may return the product within thirty (30) days of purchase for a full refund, provided the product is not opened, altered, or adulterated in any manner, less any shipping and handling charges of any sort. Use of the product, or retention of the product beyond thirty (30) days, constitutes your acceptance of this limited and exclusive warranty. No customer, distributor, or representative of ours is authorized to change or modify the published data sheets or this warranty in any way. No one is authorized to make oral warranties on behalf of us.